

HAWAII LAND SURVEYORS ASSOCIATION

Lae J Lae A newsletter from the Hawaii Land Surveyors Association, an affiliate of the National Society of Professional Surveyors and a member organization of the American Congress on Surveying and Mapping

July-August
2019
Volume 32, Issue 4



E-mail: hlsa-hawaii@outlook.com

Website: www.hlsahawaii.org

PRESIDENT'S MESSAGE

Aloha kākou, e na mea ana 'āina āpau,

As many of you know, there is a lot expected of surveyors, even though most people are barely scratching the surface when they think about what it is we do. Many of our own clients won't know all of what we do for them because most of the time we do it so well that problems don't enter the picture. We, as professionals, usually don't give our clients a reason to stop and reflect on the abilities of their surveyor because they expect our work to be done well and we accommodate.

That being said, it has been a reoccurring theme in the surveying field to have our fees for professional services questioned with no small amount of skepticism. It's as if we are thought of as engaging in some sort of price gauging conspiracy, perpetually overcharging the guileless for what they perceive as a simple map, an indecipherable description, and a couple of pipes in the ground with fancy ribbon. But much of what our clients see of our work, if they see anything at all, is usually as follows: showing up with our camera thingy and candy-caned prism wand, taking some measurements, making some notes in our little books, putting some nails and pipes in the ground, and handing over a map and description and calling it a day. What they don't see is the hours of research and calculation we have to put in before we even START the field work. They don't see us return to the job site days after the initial survey, on some occasions several times, to look for more pipes or tie in more improvements or triple check our measurements because what we found doesn't quite fit the record like it should. They don't see us wake up in the early hours of the morning wondering if we held the right boundary corners or if we should have looked longer, tried harder or dug deeper to find that pipe or that document or that field book that might shed more light on the client's problem. They don't see us pouring through pages of legal journals and court cases to find precedent in solving their boundary dispute. They don't see us checking, cross checking, and then re-cross sideways upside down checking our translations of old Hawaiian documents. All of which were written in a flowing cursive a hundred and fifty years ago and have been copied, then recopied, then placed onto microfilm, then finally incautiously scanned and indexed with a more-than-somewhat-unwieldy software in an understaffed government office. They don't see us write and edit and re edit and re write our expert testimony. They don't see us struggle so much harder to do the right thing when we could have saved ourselves the headache and done the expedient thing. They don't see us juggling our personal time with our professional time, sweating on the weekends, on holidays, and into the night to fix, solve and settle someone else's problem because that is what they paid us to do and come Hell or high-water we are going to do it to the best of our ability.

This is what we do as surveyors. And while not all of our work is visible to the client, and it may never become apparent to those professions that require our services to do their own work, if we don't advocate for ourselves and our accomplishments, no one else will. We know how much blood sweat and tears goes into our work and we need to value it. We don't need accolades, we just need to value ourselves and each other. We are professionals, ladies and gentlemen, so don't sell your time, your energy and your expertise short. You are a surveyor and no one can take that from you except you.

Mahalo a me ke aloha, Meyer Cummins, LPLS 2019 HLSA President

**E
A
L
I
L
A
E
L
A
E
L
A
E
L
A
E**
Point to Point

HAWAII LAND SURVEYORS ASSOCIATION
PRESENTS
The 2019 Annual Dinner Meeting
Food and Drinks provided by our HLSA Sustaining Members

At Atherton Hālau, Bishop Museum
Friday, October 18, 2019
1525 Bernice St, Honolulu, HI 96817



Starting at 4:00 PM
Drinks & Pupus at 5:00pm
Dinner begins at 6:00 pm
“Guest speaker to be announced”
Followed by a general membership meeting

Enjoy an afternoon and evening with fellow Hawaii surveyors, food and drinks donated by member organizations. \$5 parking at Bishop Museum before 5PM or \$3 parking after 5PM. Free street parking upon availability.



Atherton Hālau & Bowman Hālau Wa'a



Photo Credit: Bishop Museum
(See Reverse side for map of area)

HLSA 2019 Annual Dinner Meeting

REGISTRATION FORM

If giving a headcount for your company, please put your contact information as well as total headcount.

Please Print

Name & Company: _____

Mailing Address: _____

City: _____ **State:** ____ **Zip:** _____ **Bus. Phone:** _____

Total Headcount: _____

No charge to attend, members & non-members welcome (all food & drinks are donated)

Please submit registration form to HLSA, subject: HLSA Annual Dinner, ATTN: Christina Villa
via Email hlsa-hawaii@outlook.com

for more information contact Christina Villa by phone or text message @ 690-1714
(Please RSVP by Oct. 11, headcount for attendance is important)

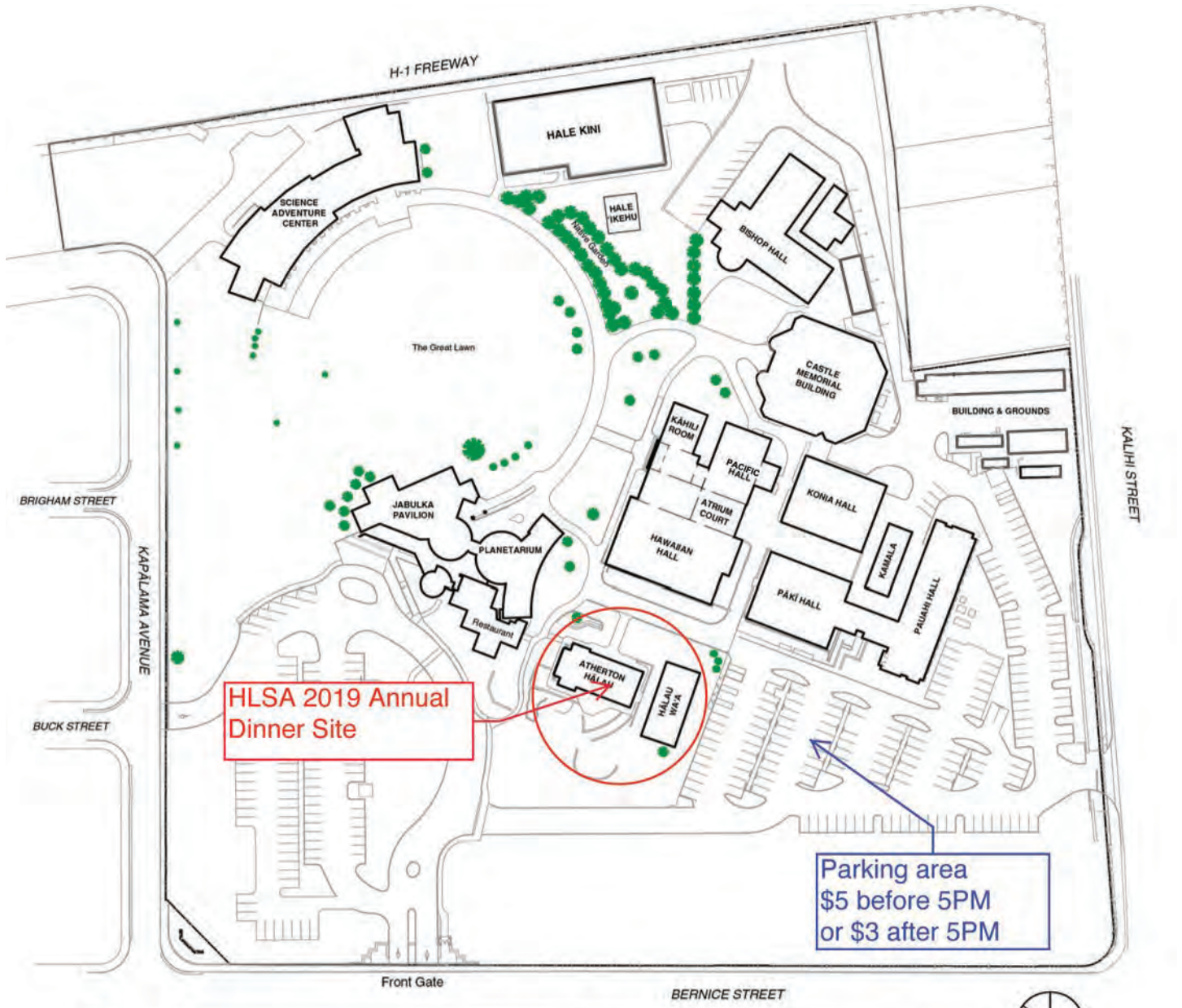

The Grounds of
BERNICE PAUHAH BISHOP MUSEUM
 Honolulu, Hawai'i

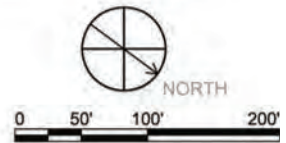

November 2010

HAWAII LAND SURVEYORS ASSOCIATION
2019 WORKSHOP SERIES

SURVEYING MATH BASICS



PRESENTED BY:

ANDY HARADA, LPLS
KENN NISHIHARA, LPLS
WAYNE TERUYA, LPLS



BRING YOUR SCIENTIFIC CALCULATOR!

WHEN: **SATURDAY, OCTOBER 26, 2019, 9:30 AM TO 2:30 PM**

WHERE: **ENTREPRENEURS SANDBOX**
643 ILALO STREET HONOLULU, HI 96813



FREE ATTENDANCE FOR HLSA MEMBERS

\$30.00 FOR NON-MEMBERS

On-site parking is \$6.00 or park on the street.
Bring lunch or order from near by restaurants.
Coffee and drinks and snacks will be provided.

PLEASE RSVP TO hlsa-hawaii@outlook.com BY OCT. 19, 2019

If you have questions, call Joanne Williamson at 436-6725

Surveyor of the Year

Nomination Form

A prestigious award to acknowledge those members who have given of themselves in a special way by their exceptional contributions to the advancement of the surveying profession and their outstanding service in civic and community affairs. Their technical and professional accomplishments including their current activities as a surveyor are also recognized.

Sponsors submitting a nomination must be a licensed land surveyor in the State of Hawaii and a member of the Hawaii Land Surveyors Association.

Eligibility Requirements:

- a. Licensed land surveyor in the State of Hawaii
- b. Resident of Hawaii
- c. Must be a member of the Hawaii Land Surveyors Association
- d. No prior record of disciplinary action by the State of Hawaii and DCCA
- e. No prior felony convictions



1. _____ (name of nominee) _____ (company name)

2. Contributions to the Surveying Profession: _____

3. Community Service and Activities: _____

4. Technical and Professional Accomplishments: _____

5. Professional Organizations and Involvement: _____

6. Please list two (2) references of the nominee:

_____	_____	_____
(first, last name)	(company)	(phone number)
_____	_____	_____
(first, last name)	(company)	(phone number)

7. Name of Sponsor making nomination: _____ phone: _____

(please mail nomination forms to HLSA, P.O. Box 2981, Honolulu, HI 96802)
deadline to submit is December 6th

Hawaii Land Surveyors Association

SURVEYORS LIFETIME ACHIEVEMENT AWARD

WHO IS ELIGIBLE?

Any member or past member of the Hawaii Land Surveyors Association in good standing is eligible for nomination for the Lifetime Achievement Award. Nominee must be a licensed surveyor in the State of Hawaii and a current resident. If a person has received a Lifetime Achievement Award, he or she is not eligible to receive the same award again.

NOMINATION PROCESS

Nominations will only be deemed valid when submitted on an official Lifetime Achievement Award Nomination Form by December 6th.

SELECTION COMMITTEE

The selection committee shall be comprised of 3 surveyors who are members in good standing with HLSA and appointed to a 2 year term by the President of HLSA.

SELECTION CRITERIA

The following guidelines will be used in, but not limited to, making a selection:

1. A record of commitment and business success in the surveying profession
2. Contributions over an extended period of time, as opposed to a single or short-term effort
3. Integrity and character deserving of the award
4. Currently or previously held a position of leadership within his/her corporation, business, or government agency

Name of Nominee: _____ Phone: _____

Education: _____

Business/Position: _____

Describe how the nominee meets the guidelines for this award:

Sponsor's Name: _____ Phone: _____

(pls mail nomination forms to HLSA, PO Box 2981, Honolulu, HI 96802 by Dec. 6th)

SALE!

Used Equipment



• Trimble TS662
Total Station
\$4,250



• Leica Rugby 840
Rotating Laser
\$1,500



• Leica Rugby 820
Rotating Laser
\$1,250



• Pro Shot L5
Rotating Laser
\$400



• Leica GRX1200 Pro
Reference Receiver &
RX1220T Data Collector
\$5,000



• Spectra DG511 Pipe
Laser
\$2,100



• Leica Piper 200 Pipe
Laser
\$1,850



• Getac PS336E With
MicroSurvey FieldGenius
V7 – Total Station & GNSS
\$1,500



• Getac PS336E With
MicroSurvey FieldGenius
V7 – Total Station
\$1,200



• Spectra Ranger 3
With Survey Pro
\$1,900



• Subsurface
Instruments ML-1M
Magnetic Locator
\$600



• senseFly eBee+ RTK
Survey Drone
\$9,000



• Leica NA730
Autolevel
\$675

For more info please call:

(808) 676-7944

Or email: sales@surveyorshawaii.com

Surveyors Supply Company, Inc.

94-356 Uke'e St Unit A, Waipahu, HI 96797

SSCI

ITEM	CONTENTS/DETAILS	PRICE
Trimble TS662 Total Station	Includes: Trimble TS662 Total Station, 2 Batteries, Battery Charger, Hard Case	\$4,250
Leica Rugby 840 Multipurpose Rotating Laser	Includes: Leica Rugby 840, RC400 Remote, Rod Eye Receiver, Hard Case	\$1,500
Leica Rugby 820 Manual Slope Rotating Laser	Includes: Leica Rugby 820, Rod Eye Receiver, Hard Case	\$1,250
Pro Shot L5 Rotating Laser	Includes: Pro Shot L5, Batteries	\$400
Leica GRX1200 Pro Reference Receiver with RX1220T Data Collector	Includes: Leica GRX1200 Pro Reference Receiver & RX1220T Data Collector	\$5,000
Spectra DG511 Pipe Laser	Includes: Spectra DG511, Target, Target Holder, Batteries, Battery Charger, Remote Control	\$2,100
Leica Piper 200 Pipe Laser	Includes: Leica Piper 200, Target, Target Holder, Trivet Mount, Batteries, Battery Charger, Remote Control	\$1,850
Getac PS336E With MicroSurvey FieldGenius V7 – Total Station & GNSS	Includes: Getac PS336E with MicroSurvey FieldGenius V7 – Standard + Advanced + Total Station + Robotic + GNSS License, Battery	\$1,500
Getac PS336E With MicroSurvey FieldGenius V7 – Total Station	Includes: Getac PS336E with MicroSurvey FieldGenius V7 – Standard + Total Station + Robotic License, Battery	\$1,200
Spectra Ranger 3 With Survey Pro	Includes: Spectra Ranger 3 with Survey Pro Total Station Module	\$1,900
SubSurface Instruments ML-1M Magnetic Locator	Includes: ML-1M Magnetic Locator, Soft Bag, Batteries	\$600
senseFly eBee+ RTK Survey Drone	<i>Please contact us for contents/details.</i>	\$9,000
Leica NA730 Automatic Level	Includes: Leica NA730 Autolevel, Hard Case, Rain Cover	\$675



2019 Sustaining Members:

Austin, Tsutsumi & Associates, Inc.

ControlPoint Surveying Inc.

Engineers Surveyors Hawaii, Inc.

Frontier Precision

HUBS Hawaii, Inc.

Kamehameha Schools

KN Surveying, LLC

ParEn, Inc.

Sam O. Hirota, Inc.

Surveyors Supply Co., Inc.

Stantec

2019 Board of Directors

President: Meyer Cummins
email: meycummins@hlcsurvey.com

Vice President: Karl Nishio
phone: 808-524-7100

Treasurer: Alika Garo
phone: 237-3223

Secretary: Donna Gonzales
phone: 808-226-3822

Director: Christina Villa
phone: 808-690-1714

Director: Cliff Yim
email: cyim@knsurveying.com

Director: Leo Bell
email: lcb33@humboldt.edu

Director: Erick Wenceslao
email: erick.wenceslao@aecom.com

NSPS Director: Joanne Williamson
phone: 808-543-7881

Past President: Karl Nishio

Editor: Christina Villa